



### ATTENTION

**Do not allow the conductive garments to touch together when turning on, during treatment, or making adjustments to the intensity of the ReBuilder® unit.**

**It is important to carefully unsnap the lead wire from the conductive garment after use. Dry the snap connectors and the snaps on the garments before putting them away. This helps maintain optimal function of the garments.**



### NOTE

**Even if you have used Conductive Garments before, please read these instructions completely as information may have changed.**

## QUESTIONS

For questions about this product...



Call us toll free at  
**(877) 717-5487**



Visit us on the Web  
**www.ReBuilderMedical.com**



Or email us at  
**help@ReBuildermedical.com**



## Warranty Information

All warranty claims are to be processed by the manufacturer directly and must be accompanied by a receipt or in your order history for proof of purchase.

**FOR WARRANTY-RELATED ISSUES PLEASE CALL BEFORE RETURNING TO REBUILDER® MEDICAL INC.**

For questions concerning warranty, mechanical or operational problems with your ReBuilder® unit or accessories, please call toll free **877-717-5487**.

v240906



**ReBuilder Medical Inc.**  304 - 725 - 4915  
 304 - 725 - 2202  
 636 Treeline Drive, Charles Town, WV 25414

Please read all the information in this booklet before beginning treatment with the Conductive Socks.

Verify the contents of your package:

- A. Conductive Garment Socks with attached snap connectors.
- B. ReBuilder® Electrolyte Spray.



## Care & Cleaning

Rinse with fast running warm water or sprayer and hand wash with mild soap as needed. Allow socks to air dry. Ensure snap connectors and grommets are completely dry before storing the socks in a dry location.

### DO NOT MACHINE WASH OR DRY.

These products are supplied as extra products for your convenience. Many physicians will recommend these garments with use of electrical stimulation devices. These garments may assist in the treatment for pain but are not necessary for use with ReBuilder products.

## Using the Conductive Socks

1. Wash your feet with soap and water.
2. Wet the Conductive Socks under fast running warm water. Blot excess with a towel so they do not drip.
3. Spray the foot or inside of each sock with Electrolyte solution about 5-6 times covering the entire area.

### Putting on the Conductive Socks

Roll the Conductive Socks onto each foot, being careful to avoid pulling as much as possible.



### Connecting the Snaps

Connect the Conductive Socks to your ReBuilder by inserting one of the metal probes on the end of the lead wire into each snap connector. The snap connector is made of black plastic and is attached to the sock by a metal grommet. (Fig. 1)



**It does not matter if the snap is on the inside or outside of your leg.**

**Color of the snap may vary.**

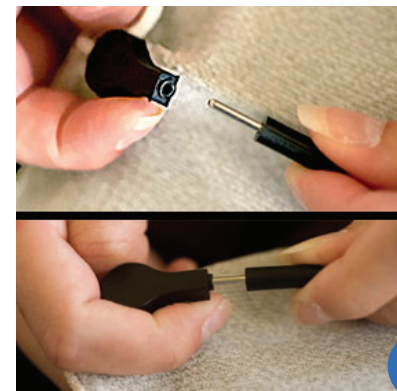

Fig. 1

Cover with disposable sock covers if desired once snaps and lead wires are both connected.

### Connecting to the Stimulator

Attach lead wire into the top of your ReBuilder stimulator. Please note the irregular shape of the output jack and the end of the lead wire so that you insert the wire correctly. (Fig. 2)

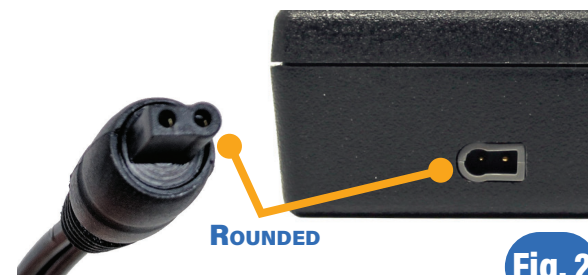

Fig. 2

Turn your ReBuilder on and slowly adjust the intensity as directed.

\*These instructions represent the best standard practice and may be modified by your medical provider or suggestions from ReBuilder to meet your treatment needs.